

Colder Products Company: PMC Series

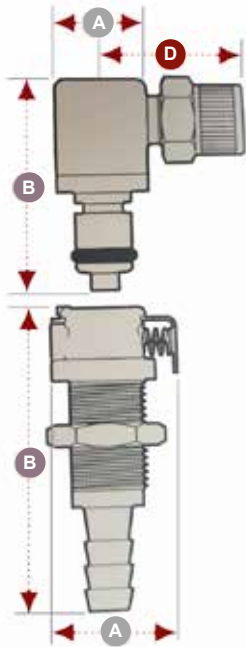

- A** = Height/Diameter
- B** = Total Length
- D** = Elbow Radial Length

Technical Specification

- Pressure: Vacuum to 120 psi, 8.3 bar
- Temperature: -40°F to 180°F (-40°C to 82°C)
- Colour: Natural white, others available
- Tubing sizes: 1.16" to 1/4" ID, 1.6mm to 6.4mm ID
- Materials:
 - Main components and valves: Acetal
 - Thumb latch: Stainless Steel
 - Valve spring: 316 Stainless Steel
 - External springs and pin: Stainless Steel
 - O-rings: Buna-N

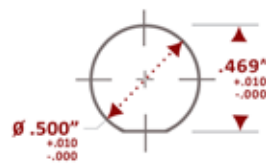

	Panel Opening	Panel Thickness Max. - Min.	Panel Nut Hex	Panel Nut Thread
Coupling Bodies	See Drawing	.50 - .05	5/8	1/2 - 24UNS
Coupling Inserts	1/2	.30 - .05	5/8	1/2 - 24UNS

WARNING: Pressure, temperature, chemicals, and operating environment can affect the performance of couplings. It is the customers responsibility to test the suitability of Colder Products in their own application conditions.

Acetal Coupling Bodies

Termination	Thread Size	Metric EQ.	Straight Thru	Shut Off	A	B
In-Line Pipe Thread	1/8" NPT		PMC1002	PMCD1002	.79	1.00
	1/8" BSPT		PMC1002BSPT	PMCD1002BSPT	.79	1.00
	1/4" NPT		PMC1004	PMCD1004	.79	1.10
	1/4" BSPT		PMC1004BSPT	PMCD1004BSPT	.79	1.10
Panel Mount Ferruleless Polytube Fitting, PTF†		4.0mm OD, 2.0mm ID	PMC12M42	PMCD12M42	.77	1.65
	5/32" OD, .10" ID	4.0mm OD, 2.5mm ID	PMC12025	PMCD12025	.77	1.70
	1/4"OD, .17" ID	6.4mm OD, 4.3mm ID	PMC1204	PMCD1204	.77	1.72
Panel Mount Hose Barb	1/16" ID	1.6mm ID	PMC1601	PMCD1601	.77	1.40
	1/8" ID	3.2mm ID	PMC1602	PMCD1602	.77	1.65
	3/16" ID	4.8mm ID	PMC1603	PMCD1603	.77	1.85
	1/4" ID	6.4mm ID	PMC1604	PMCD1604	.77	1.85



Colder Products Company: PMC Series

Acetal Coupling Bodies (Continued)

Termination	Thread Size	Metric EQ.	Straight Thru	Shut Off	A	B
Panel Mount Female Thread	10-32 UNF		PMC181032	PMCD181032	.77	1.25
In-Line Ferruleless Polytube Fitting, PTF†		4.0mm OD, 2.0mm ID	PMC13M42	PMCD13M42	.81	1.65
	5/32" OD, .10" ID	4.0mm OD, 2.5mm ID	PMC13025	PMCD13025	.81	1.65
		5.0mm OD, 3.0mm ID	PMC13M5	PMCD13M5	.81	1.72
	1/4" OD, .17" ID	6.4mm OD, 4.3mm ID	PMC1304	PMCD1304	.81	1.75
In-Line Hose Barb	1/16" ID	1.6mm ID	PMC1701	PMCD1701	.81	1.41
	1/8" ID	3.2mm ID	PMC1702	PMCD1702	.81	1.45/1.65
	3/16" ID	4.8mm ID	PMC1703	PMCD1703	.81	1.65/1.85
	1/4" ID	6.4mm ID	PMC1704	PMCD1704	.81	1.65/1.85
In-Line Female Thread	10-32 UNF		PMC 191032	PMCD191032	.81	1.25



Acetal Coupling Inserts

Termination	Thread Size		Straight Thru	Shut Off	A	B	D
In-Line Pipe Thread	1/8" NPT		PMC2402	PMCD2402	.58	1.03/1.45	
	1/8" BSPT		PMC2402BSPT	PMCD2402BSPT	.58	1.03/1.44	
	1/4" NPT		PMC2404	PMCD2404	.65	1.13/1.42	
	1/4" BSPT		PMC2404BSPT	PMCD2404BSPT	.65	1.13/1.42	
Panel Mount Ferruleless Polytube Fitting, PTF† (non valved shown)	1/4" OD, .17" ID	6.4mm OD, 4.3mm ID	PMC4004	PMCD4004	.72	1.70/1.82	
Panel Mount Hose Barb	1/16" ID	1.6mm ID	PMC4201	PMCD4201	.72	1.38/1.50	
	1/8" ID	3.2mm ID	PMC4202	PMCD4202	.72	1.63/1.75	
	3/16" ID	4.8mm ID	PMC4203	PMCD4203	.72	1.83/1.95	
	1/4" ID	6.4mm ID	PMC4204	PMCD4204	.72	1.83/1.95	

Colder Products Company: PMC Series

Acetal Coupling Inserts (Continued)

Termination	Thread Size		Straight Thru	Shut Off	A	B	D
In-Line Ferruleless Polytube Fitting, PTF†		4.0mm OD, 2.0mm ID	PMC20M42	PMCD20M42	.58	1.08/1.60	
	5/32" OD, .10" ID	4.0mm OD, 2.5mm ID	PMC20025	PMCD20025	.58	1.13/1.65	
	1/4" OD, .17" ID	6.4mm OD, 4.3mm ID	PMC2004	PMCD2004	.58	1.15/1.57	
	3/8" OD, .25" ID	9.5mm OD, 6.4mm ID	PMC2006	PMCD2006	.65	1.40/1.52	
In-Line Hose Barb	1/16" ID	1.6mm ID	PMC2201	PMCD2201	.50	.80/1.47	
	1/8" ID	3.2mm ID	PMC2202	PMCD2202	.50	1.00/1.67	
	3/16" ID	4.8mm ID	PMC2203	PMCD2203	.50	1.20/1.88	
	1/4" ID	6.4mm ID	PMC2204	PMCD2204	.50	1.22/1.70	
(non valved shown)							
In-Line Female Thread	10-32 UNF		PMC281032	PMCD281032	.58	.63/1.31	
Elbow Ferruleless Polytube Fitting, PTF†	5/32" OD, .10" ID	4.0mm OD, 2.5mm ID	PMC21025		.50	1.17	.75
	1/4" OD, .17" ID	6.4mm OD, 4.3mm ID	PMC2104	PMCD2104	.50	1.17/1.21	.77
Elbow Hose Barb	1/8" ID	3.2mm ID	PMC2302	PMCD2302	.50	.85/1.21	.75/.69
	1/4" ID	6.4mm ID	PMC2304	PMCD2304	.50	1.00/1.21	.95/.90
(non valved shown)							



All the measurements are in inches (millimeters) unless otherwise noted. Tubing must meet stated inside and outside diameters.

†NOTE: CPC's Ferruleless PTF (Poly tubing) terminations do not require ferrules to achieve a secure connection and are therefore easier to use and reuse. PTF fittings are designed for semi-rigid tubing, i.e., Polyethylene, Nylon, Polyurethane, ect.

