

Dry-Disconnect: Snap-tite 71 Series

Technical Specification



- Materials:
 - Steel, Zinc trivalent plating
 - 316 Stainless Steel
 - High Pressure Stainless Steel
- Pressure: Up to 10,000 PSI (690 Bar) (Depending on size & material)
- Sizes: 1/4" - 2"
- Flush face/dry break
- Push-to-connect

Features & Benefits

- Available with a sleeve lock design to protect against accidental disconnection
- Available with Autoclave cone and threaded fittings
- Versatile

Applications

- High pressure hydraulics
- Offshore oil and gas
- Pharmaceuticals

Size: 1/4" thru 1-1/4"††

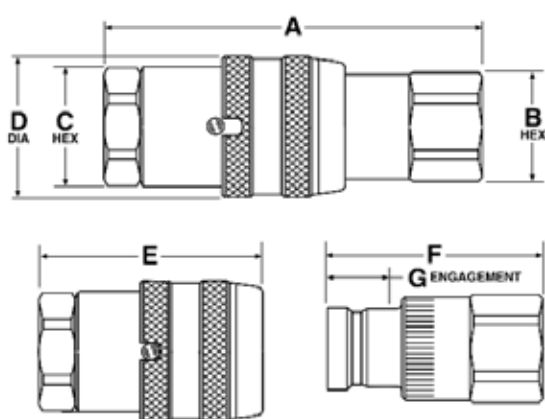

Size	A	B (Hex)*	C (Hex)*	D (Dia.)	E	F	G
1/4" (mm)	3.27 (83.06)	0.81 (20.57)	0.94 (23.88)	1.19 (30.23)	1.96 (49.78)	1.84 (46.74)	0.53 (13.46)
3/8" (mm)	4.00 (101.60)	1.00 (25.40)	1.19 (30.23)	1.56 (39.62)	2.36 (59.95)	2.32 (58.93)	0.68 (17.27)
1/2" (mm)	4.43 (112.52)	1.50 (38.10)	1.50 (38.10)	1.88 (47.75)	2.77 (70.36)	2.38 (60.45)	0.72 (18.29)
3/4" (mm)	5.13 (130.30)	1.75 (44.45)	1.75 (44.45)	2.25 (57.15)	3.05 (77.47)	2.96 (75.18)	0.88 (22.35)
1" (mm)	5.60 (142.24)	1.88 (47.75)	2.00 (50.80)	2.63 (66.80)	3.32 (84.33)	3.23 (82.04)	0.95 (24.13)
1-1/4" (mm)	6.22 (157.99)	2.00 (50.80)	2.00 (50.80)	2.63 (66.80)	3.67 (93.22)	3.50 (88.90)	0.95 (24.13)

* Hex dimensions are taken from flat of hex and not across corners. Hex may be substituted with round stock. Hex column would then indicate dimension taken across wrench flats.

Decimal dimensions are ± .06 in. (1.5mm).

Dimensions are subject to change without notice.

Part configurations are typical and do not necessarily represent actual appearance.

††Note: 1/4" thru 1-1/4" are flush face couplings. 1-1/2" & 2" maintain a recessed face on coupler half.

Dry-Disconnect: Snap-tite 71 Series

Size: 1-1/2"

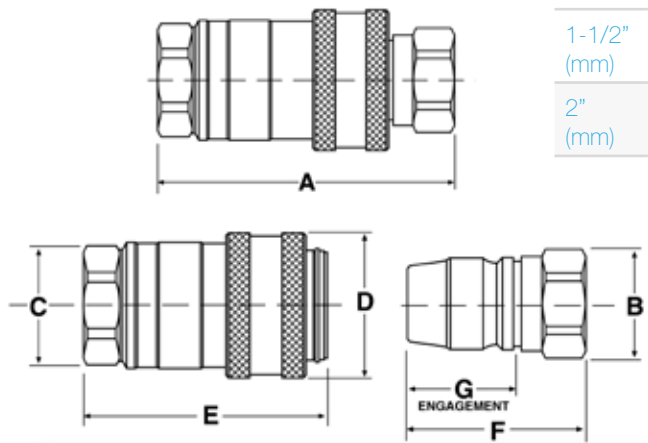

Size	A	B (Hex)*	C (Hex)*	D (Dia.)	E	F	G
1-1/2" (mm)	7.60 (193.04)	3.25 (82.55)	3.38 (85.85)	4.50 (114.30)	6.21 (157.73)	4.50 (114.30)	3.21 (81.53)
2" (mm)	7.60 (193.04)	3.25 (82.55)	3.38 (85.85)	4.50 (114.30)	6.21 (157.73)	4.65 (118.20)	3.21 (81.53)

* Hex dimensions are taken from flat of hex and not across corners. Hex may be substituted with round stock. Hex column would then indicate dimension taken across wrench flats.

Decimal dimensions are $\pm .06$ in. (1.5mm).

Dimensions are subject to change without notice.

Part configurations are typical and do not necessarily represent actual appearance.

††Note: 1/4" thru 1-1/4" are flush face couplings. 1-1/2" & 2" maintain a recessed face on coupler half.

Pressure Ratings

Size	Spillage (cc)	Air Inclusion (cc)	Steel				316 Stainless Steel				High Pressure Stainless Steel			
			Max Working		Min Burst*		Max Working		Min Burst*		Max Working		Min Burst*	
			PSI	Bar	PSI	Bar	PSI	Bar	PSI	Bar	PSI	Bar	PSI	Bar
1/4"	0.02	0.01	10,000	689	20,000	1379	5,000	344	12,500	862	10,000	689	20,000	1379
3/8" x 1/4" ¹	0.02	0.02	10,000	689	20,000	1379	5,000	344	12,500	862	10,000	689	20,000	1379
3/8"	0.02	0.02	10,000	689	20,000	1379	5,000	344	12,500	862	10,000	689	20,000	1379
3/8" x 1/2" ²	0.02	0.02	10,000	689	20,000	1379	5,000	344	12,500	862	10,000	689	20,000	1379
1/2"	0.03	0.03	10,000	689	20,000	1379	5,000	344	12,500	862	10,000	689	20,000	1379
3/4"	0.06	0.04	7,500	517	15,000	1034	5,000	344	12,500	862	7,500	517	15,000	1034
1"	0.10	0.06	7,500	517	15,000	1034	4,000	275	10,000	689	7,500	517	15,000	1034
1" x 1-1/4" ³	0.10	0.06	7,500	517	15,000	1034	4,000	275	10,000	689	7,500	517	15,000	1034
2" x 1-1/2" ⁴	5.25	30.50	5,000	344	10,000	689	3,000	206	6,000	413	5,000	344	10,000	689
2"	5.25	30.50	5,000	344	10,000	689	3,000	206	6,000	413	5,000	344	10,000	689

¹Unit is 3/8" with 1/4" end fitting

²Unit is 3/8" with 1/2" end fitting

³1" unit with 1-1/4" end fitting

⁴2" unit with 1-1/2" end fitting

*NOTE: Pressure Ratings were established under static pressure conditions. For high impulse applications, consult the Quick Disconnect Range.

Dry-Disconnect: Snap-tite 71 Series

Ordering Information

